

Simply
Exclusive

clear**water**[®]
BATHS

Luxurious free-standing baths





Vicenza Petite ClearStone Bath, page 27

Introduction

Clearwater have used international designers to bring together a stunning and elegant range of free-standing baths using the finest materials and engineering. Our innovative material ClearStone has a lustrous finish across modern and classic designs, whereas velvety Natural Stone allows for refined edges and more complex designs across a selection of baths and basins. Choose modern designs that reflect today's contemporary styles, or Classic free-standing, roll top designs with period style.

INDEX:

For full index see inside back cover.

DESIGN. THE MODERN COLLECTION *Pages 05 to 37*

Our beautifully crafted and extensive modern collection has been designed to offer the very best of contemporary style. By using the best materials, our designers have created baths with thinner rims, increasing the internal space whilst allowing for smaller external sizes. So now free-standing baths can fit into bathrooms of modest size, providing an eye-catching centrepiece and that extra piece of luxury. Many of our popular models are available in Grande and Petite sizes, with the Petite internal space just as generous as most conventional baths.

DESIGN. THE CLASSIC COLLECTION *Pages 39 to 46*

For a true vintage look in your bathroom, choose from our range of Classic models, covering every installation and size requirement. There are roll top baths with a choice of feet in various styles and colours, so you can tailor your bath to your own individual tastes and to work seamlessly with your own décor and bathroom surroundings.

MATCHING BASINS *Page 66 to 67*

To co-ordinate with our baths, several designs have matching basins crafted from both ClearStone and Natural Stone, to continue the feeling of luxury throughout your bathroom. Choose from sleek modern designs or Classic shapes to complement your chosen bath.

TAPS AND MIXERS *Page 68 to 75*

To complete the picture we have partnered up with Britton and Burlington to provide both exceptional modern and Classic brassware, which lead the field in innovation.



Palermo Grande ClearStone Bath, page 18



Nuvola ClearStone Bath, page 16



Romano Grande ClearStone Bath, page 45



Sontuoso Basin, page 13 & Modern Basin Taps, page 69



INSTALLATION. All our baths are designed with simple installation in mind. Full instructions and drawings are available on our website and can be downloaded so the installer can prepare and first fix, ready for when the bath arrives. All Natural Stone and ClearStone baths are carefully packaged for full protection during transit and all Natural Stone and ClearStone baths come with a multi-handle carrier to help handling on site.



Materials, engineering & installation

Clearwater has years of experience in designing and making free-standing baths and only use the highest quality materials.

ALL OF OUR BATHS ARE DESIGNED TO PROVIDE:



A non-toxic and eco-friendly material which is safe on the skin.



Non-porous, resistant to staining or discolouring



Easy Clean material with high resistance against bacteria, mould and dirt.



Good thermal insulation properties, keeping the water temperature warmer for longer.

- Designed with thin edges to ensure maximum bathing space – a 1600mm Clearstone bath has the equivalent bath space as a 1700mm standard bath.
- One piece solid surface bath.
- Available in both modern and classic designs with a variety of sizes.

CLEARSTONE:

This advanced, new material is a fusion of milled sedimentary stone bonded by a high performance aluminium and titanium filler base. The result creates a hardwearing, high gloss surface in a brilliant white colour, with exceptional performance engineered to last a lifetime.

- Aluminium and titanium compound with a stone carbonate base creates an exceptionally strong material, with a high resistance to scratching or chemical damage.
- Moulded polyester polymer coating giving hard wearing high gloss finish.
- High strength to weight ratio with most baths weighing under 100kgs.
- Thinner, more delicate edge outlines - tapering profiles give an overall softer, more sophisticated appearance.

NATURAL STONE:

The hand polished solid surface material remains a favourite with architects and designers, who appreciate the sharp edging and unique sheen of this material.

This unique hand crafted aspect of 'Natural Stone' will continue, being best suited for the more radical and complex designs used in baths like the Lacrima, Lonio and Vigore.

These baths offer:

- Sharper lines
- Hand polished for over ten hours
- No unsightly joins
- Clean dynamic lines
- Small scratches and blemishes can be polished out
- The Natural Stone material is suited to the more complex bath shapes

Modern

Clearwater has an extensive range of free-standing modern baths in both Natural Stone and ClearStone, in Grande and Petite sizes, a solution suitable for smaller bathrooms. Alternatively, choose from beautiful, ergonomic baths, shaped to provide the ultimate relaxing bathe. All are exquisitely crafted to provide a gorgeous centrepiece in contemporary bathroom settings.

ClearStone	Duo, <i>page 05</i>
	Patinato Grande & Patinato Petite, <i>page 06-07</i>
	Formoso Grande & Formoso Petite, <i>page 08-11</i>
	Sontuoso, <i>page 12-13</i>
	Puro, <i>page 14-15</i>
	Nuvola, <i>page 16-17</i>
	Palermo & Palermo Petite, <i>page 18-21</i>
	Teardrop Grande & Teardrop Petite, <i>page 22-25</i>
	Vicenza Grande & Vicenza Petite, <i>page 26-27</i>
Natural Stone	Vicenza & Vicenza Piccolo, <i>page 28-29</i>
	Nebbia, <i>page 30-31</i>
	Lacrima, <i>page 32-33</i>
	Vigore, <i>page 34-35</i>
	Armonia, <i>page 36-37</i>

New Duo ClearStone bath,
Crystal bath filler on stand pipes and
click-clack bath waste.

See page 50 for technical details
on the Duo bath.

In order to make our Duo baths suitable for more
applications we have removed the integrated
overflow. You will be able to have an overflow by
using an external overflow as shown on page 76.



NEW

DUO *ClearStone* The Duo is a stunning shell-like shape with beautiful curves that blend into your bathroom surrounding. The Duo bath comfortably fits two people.

PATINATO GRANDE & PETITE *ClearStone* Gorgeous geometric angles with slim, sharp edges make this ClearStone bath and matching basin perfect for those who like distinctive geometric shapes. Choose the Petite version with a smaller footprint for bathrooms of a moderate size. Both designs feature a back to wall ledge to sit flush against a wall, maximising space in your beautiful bathroom.



Patinato Grande ClearStone bath with Sapphire single-lever bath filler and no overflow un-slotted click-clack waste. New Patinato Petite ClearStone bath and Sapphire single-lever bath filler and click-clack waste.

See page 51 for technical details on the Patinato baths.

In order to make our Patinato baths suitable for more applications we have removed the integrated overflow. You will be able to have an overflow by using an external overflow as shown on page 76.

Natural Stone equivalent is available while stocks last.



**10 YEAR GUARANTEE
ON ALL OUR BATHS**

See website for more details





FORMOSO GRANDE *ClearStone* This elegant and understated, popular bath is available in two sizes and has clean and simple lines, which create a shapely aesthetic well suited to all modern day bathrooms. Pair with the matching Formoso basin for a beautiful and design linked bathroom.

Formoso ClearStone bath with Crystal bath filler on stand pipes and click-clack waste, Formoso basin with Crystal Tall basin mixer and click-clack basin waste.

See page 52 for technical details on the Formoso Grande bath and page 66 for the Formoso basin.

In order to make our Formoso baths suitable for more applications we have removed the integrated overflow. You will be able to have an overflow by using an external overflow as shown on page 76.

FORMOSO PETITE *ClearStone* The same minimalistic, beautiful design of the Formoso Grande bath, but with a smaller 150cm length to fit into most modern bathrooms. The internal space of this bath is bigger than most full size normal baths, thanks to its narrow rim.



Formoso ClearStone basin with Crystal Tall basin mixer and click-clack basin waste. Formoso Petite ClearStone bath, Crystal single-lever bath filler on stand pipes and click-clack waste.

See page 52 for technical details on the Formoso petite bath and page 66 for the Formoso basin.

In order to make our Formoso baths suitable for more applications we have removed the integrated overflow. You will be able to have an overflow by using an external overflow as shown on page 76.



**10 YEAR GUARANTEE
ON ALL OUR BATHS**
See website for more details



SONTUOSO *ClearStone* A luxurious curvaceous bath with generous sloped sides. Partner with the Sontuoso basin in the same high gloss *ClearStone* for a seamless, matching aesthetic across other sanitaryware and even tiles. Or choose the Natural Stone basin for an interesting point of difference.



Sontuoso *ClearStone* bath, Crystal floor-standing bath filler and click-clack bath waste. Sontuoso Natural Stone basin, Crystal Tall basin mixer and click-clack basin waste.

See page 53 for technical details on the Sontuoso bath and page 66 for the Sontuoso basins.

In order to make our Sontuoso baths suitable for more applications we have removed the integrated overflow. You will be able to have an overflow by using an external overflow as shown on page 76.

Natural Stone equivalent is available while stocks last.





10 YEAR GUARANTEE
ON ALL OUR BATHS
See website for more details



PURO *ClearStone* The Puro is designed especially for the comfort of the body to ensure complete relaxation. The curvature of the innovative ClearStone material means the bath and matching basin sit seamlessly in a modern environment and softens the architectural feel of a contemporary bathroom. Also available with an additional chrome plinth for guaranteed standout appeal.

Puro ClearStone bath, Crystal floor-standing bath filler and un-slotted click-clack waste. Puro ClearStone basin, Sapphire Tall basin mixer and click-clack basin waste.

See page 54 for technical details on the Puro bath and page 66 for the Puro basin.

In order to make our Puro baths suitable for more applications we have removed the integrated overflow. You will be able to have an overflow by using an external overflow as shown on page 76.

Natural Stone equivalent is available while stocks last.





NUVOLA *ClearStone* Classic and contemporary combine to create this pure vision of elegance. Subtle curves, simple edges and a raised base give a modern twist to a timeless shape.



New Nuvola ClearStone bath, Sapphire bath shower mixer on stand pipes and click-clack bath waste.

See page 53 for technical details on the Nuvola bath.

In order to make our Nuvola baths suitable for more applications we have removed the integrated overflow. You will be able to have an overflow by using an external overflow as shown on page 76.





PALERMO GRANDE *ClearStone* Elongated, geometric shape with concave curved sides give this bath the wow factor. Available in two sizes for flexibility of space.



**10 YEAR GUARANTEE
ON ALL OUR BATHS**
See website for more details

Palermo Grande ClearStone bath, Crystal floor-standing bath filler and click-clack bath waste.

See page 55 for technical details on the Palermo Grande bath.

In order to make our Palermo baths suitable for more applications we have removed the integrated overflow. You will be able to have an overflow by using an external overflow as shown on page 76.

Natural Stone equivalent is available while stocks last.







PALERMO PETITE *ClearStone* The same beautiful bath with stylish tapered sides but with a shorter length of just 152cm. Pair with the matching basin for an overall look of sophistication and class. Also available in Grande, see page 18.



Palermo Petite ClearStone bath, Crystal floor-standing bath filler and un-slotted click-clack waste. Palermo ClearStone basin, Sapphire Tall basin mixer and click-clack waste.

See page 55 for technical details on the Palermo Petite bath.

In order to make our Palermo baths suitable for more applications we have removed the integrated overflow. You will be able to have an overflow by using an external overflow as shown on page 76.

Natural Stone equivalent is available while stocks last.



TEARDROP GRANDE *ClearStone* A unique shaped modern bath with eye-catching lines and dramatic presence. This bath comes in two sizes to provide flexibility for every sized bathroom. The Grande photographed here, is 191cm in length, whereas the Petite is just 169cm (see page 24).



**10 YEAR GUARANTEE
ON ALL OUR BATHS**
See website for more details

Teardrop Grande ClearStone bath with Crystal floor-standing bath filler and click-clack waste. Teardrop ClearStone basin with Sapphire Tall basin mixer and click-clack basin waste.

See page 56 for technical details on the Teardrop Grande bath and page 66 for the Teardrop basin.

In order to make our Teardrop baths suitable for more applications we have removed the integrated overflow. You will be able to have an overflow by using an external overflow as shown on page 76.

CLAR equivalent is available while stocks last.





TEARDROP PETITE ClearStone The Petite Teardrop, available in 169cm, is the finest option for those looking to include a free-standing bath within a slightly smaller bathroom. Exquisitely designed so the taps can be placed anywhere around the bath. Also available in Grande (see page 22).



Teardrop Petite ClearStone bath with Crystal floor-standing bath filler and click-clack waste. Teardrop ClearStone basin with Sapphire Tall basin mixer and click-clack basin waste.

See page 56 for technical details on the Teardrop Petite bath and page 66 for the Teardrop basin.

In order to make our Teardrop baths suitable for more applications we have removed the integrated overflow. You will be able to have an overflow by using an external overflow as shown on page 76.

CLAR equivalent is available while stocks last.



**10 YEAR GUARANTEE
ON ALL OUR BATHS**
See website for more details



VICENZA PETITE & GRANDE *ClearStone* A beautiful, impactful bath which adds to a general feel of luxury and sophistication but with a length of just 152cm in Petite versions to fit into smaller bathrooms. Also available in a Grande size and the additional choice of Natural Stone in two sizes to suit your own preferences (see page 28).



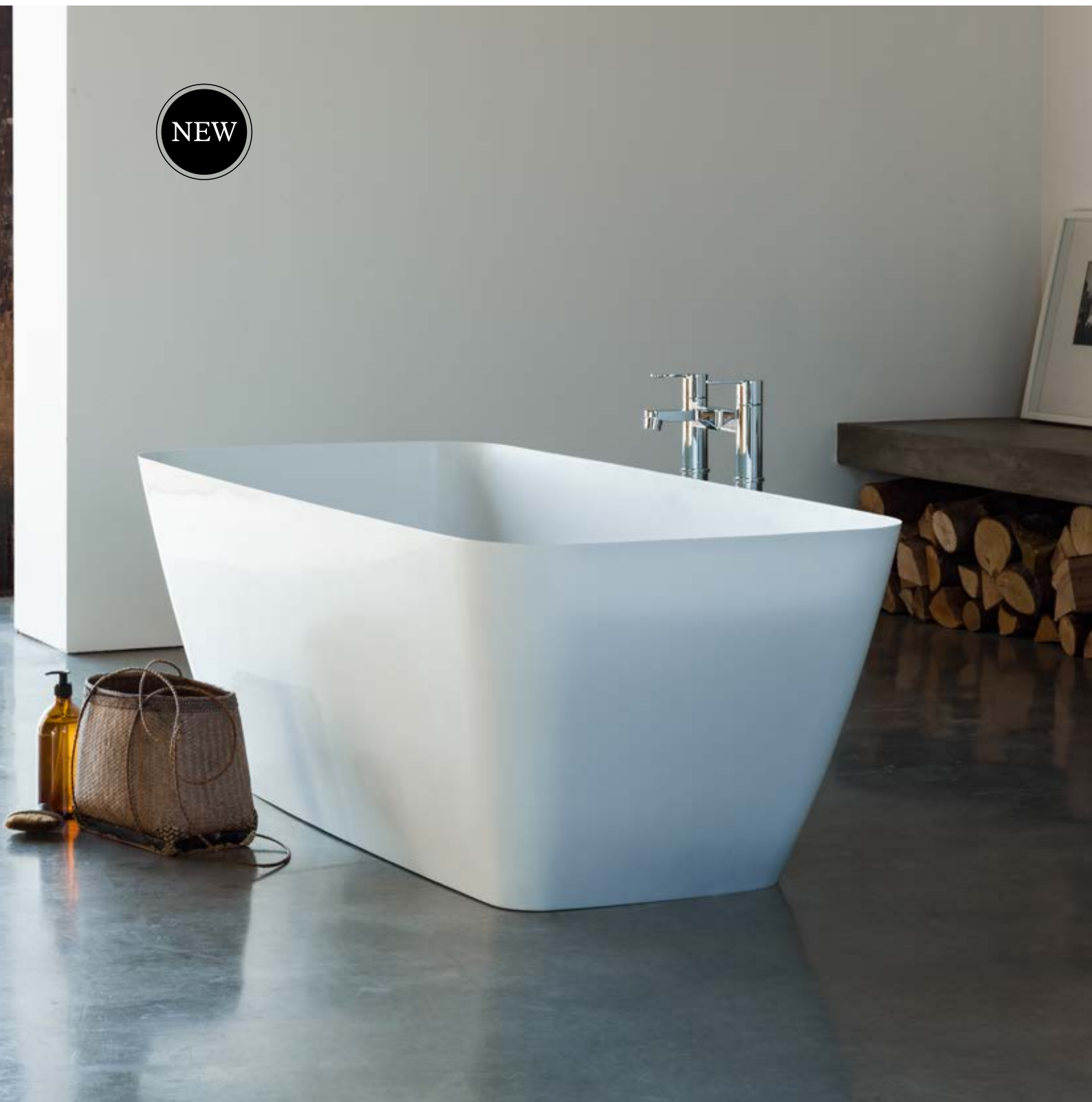

New Vicenza Petite ClearStone bath (as shown) with Crystal floor-standing bath filler and click-clack waste. Also available in Grande size. Vicenza Natural Stone basin with Crystal Tall basin mixer and click-clack basin waste.

See page 57 for technical details on the Vicenza Petite bath and page 66 for the Vincenza basin.

In order to make our Vicenza baths suitable for more applications we have removed the integrated overflow. You will be able to have an overflow by using an external overflow as shown on page 76.

VICENZA & VICENZA PICCOLO *Natural Stone*

Striking bath available in two sizes with sharp, fine edges counterbalanced with attractive curved ends. This popular style is available in both Natural Stone and ClearStone for the ultimate variety of choice. Choose from four styles depending on whether you prefer a velvety texture or lustrous, glossy finish.

Vicenza Natural Stone bath (as shown) with Crystal floor-standing bath filler and click-clack waste. Also available in Piccolo size.

See page 58 for technical details on the Vicenza Natural Stone bath.



10 YEAR GUARANTEE
ON ALL OUR BATHS
See website for more details

NEBBIA *Natural Stone* A beautiful ergonomic bath, shaped and styled to provide the ultimate, supportive bathe that feels as if you are floating. The shapely lines of this striking modern bath continue at the base meaning your entire body is supported at the perfect angle.





This bath has to be the ultimate place for relaxation. The Nebbia bath has been moulded around the human body for the ultimate feeling of comfort. The clever use of the patented channels on the side of the bath allows the water to drain, without interfering with the ergonomic shape.

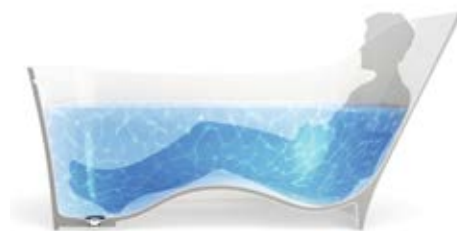

The gentle curves of the Nebbia support the human body, removing the need to 'prop' the body up with the feet on the far end of the bath.

Nebbia Natural Stone bath, Crystal floor-standing bath filler and click-clack bath waste.

See page 59 for technical details on the Nebbia bath.

NEBBIA *Natural Stone* A beautiful ergonomic bath, shaped and styled to provide the ultimate, supportive bathe that feels as if you are floating. The shapely lines of this striking modern bath continue at the base meaning your entire body is supported at the perfect angle.



LACRIMA *Natural Stone* This dramatic, oval shaped, Natural Stone bath provides an eye-catching centrepiece. With its raised stance and imposing structure, this bath is perfect for bathing with a partner. Pair with our Crystal single-lever bath filler for an elegant, architectural look.



Lacrima Natural Stone bath, Crystal floor-standing single-lever bath filler, click-clack bath waste, P-trap and P-trap connection pipe.

See page 59 for technical details on the Lacrima bath.



VIGORE *Natural Stone* The Vigore creates a stunning profile in the bathroom by raising the viewpoint off the floor with specially designed, all-in-one edged feet all made from the same Natural Stone material. For those looking for an alternative take on the floor-standing modern bath, this is the perfect choice.



Vigore Natural Stone bath, Crystal floor-standing
single-lever bath filler and click-clack bath waste.
See page 60 for technical details on the Vigore bath.

ARMONIA *Natural Stone* A classic Natural Stone shape with extra attention to detail on the thin rim and inward sloping design of the outer shape. A larger bath with a comfortably spacious interior. Pair with our Crystal bath filler on stand pipes for a striking yet simple design.

Armonia Natural Stone bath, Crystal bath filler
on stand pipes and slotted click-clack waste.
See page 60 for technical details on the Armonia bath.



**10 YEAR GUARANTEE
ON ALL OUR BATHS**
See website for more details



Classic

Clearwater's range of Classic baths is extensive and diverse with a variety of shapes and styles to suit your own individual bathroom tastes. Choose from luxurious free-standing options or beautifully classic roll top baths with a range of feet in a selection of styles and colours. For the ultimate in vintage bathroom design, select the unique Fire Hydrant waste system. See page 78 for further details.

ClearStone Balthazar, *page 39*
 Classico Grande, *page 40-41*
 Batello Grande, *page 42-43*
 Romano Grande & Petite, *page 44-45*
Natural Stone Lonio, *page 46*

Balthazar ClearStone bath with Burlington Claremont floor-standing bath shower mixer and no overflow un-slotted click-clack waste.

See page 61 for technical details on the Balthazar bath.

The Balthazar bath features a pre-drilled overflow for use with waste CW11.

NEW

BALTHAZAR *ClearStone* A dramatic, eye-catching, stainless steel outer with ClearStone internal for those preferring an attention grabbing centre-piece to their eclectic bathroom.



CLASSICO GRANDE *ClearStone* Divine double-ended rolltop bath that will add a touch of class in any environment. With a choice of feet, you can customise this beautiful bath to your individual tastes. Pair with central deck-mounted taps for a truly relaxing bathe with taps close at hand to top-up. For feet options see page 64.



Right: Classico Grande ClearStone bath with chrome Claw feet, Burlington Claremont deck-mounted bath shower mixer with decorative shrouds, click-clack waste, P-trap and P-trap connection pipe. Classico baths can be used with a Fire Hydrant waste, see page 78. Above: Burlington Large roll top basin with stainless steel stand, Burlington Claremont one tap-hole basin mixer, click-clack basin waste and classic basin bottle trap.

See page 61 for technical details on the Classico Grande bath.

In order to make our Classico Grande baths suitable for more applications we have removed the integrated overflow. You will be able to have an overflow by using an external overflow as shown on page 76.

Natural Stone equivalent is available while stocks last.





Batello Grande ClearStone bath with black Claw feet, Burlington Claremont floor-standing bath shower mixer, click-clack waste, P-trap and P-trap connection pipe.
The Batello bath can be used with a Fire Hydrant waste, see page 78.

See page 62 for technical details on the Batello Grande bath.

In order to make our Batello Grande baths suitable for more applications we have removed the integrated overflow. You will be able to have an overflow by using an external overflow as shown on page 76.

Natural Stone equivalent is available while stocks last.



**10 YEAR GUARANTEE
ON ALL OUR BATHS**
See website for more details

BATELLO GRANDE *ClearStone* The sloping curves and rolled edges of this outstanding classic bath make this product a true focal point in any bathroom. Customise with feet in your choice of style and colour to tailor-make your own designed look.

For feet options see page 64.





ROMANO GRANDE & PETITE *ClearStone*

With an elegant graduating slope crafted at the perfect angle for a relaxing bathe, the Romano is a firm favourite. With the flexibility of both Grande and Petite sizes, even the most modest sized bathroom can have its own vintage styled piece of indulgence.

For feet options see page 64.

Left: Romano Petite ClearStone bath with black Claw feet, Burlington Claremont floor-standing bath shower mixer, click-clack waste, P-trap and P-trap connection pipe. Right: Romano Grande ClearStone bath with white Claw feet, Burlington Claremont floor-standing bath shower mixer, click-clack waste, P-trap and P-trap connection pipe. The Romano baths can be used with a Fire Hydrant waste, see page 78.

See page 62-63 for technical details on the Romano baths.

In order to make our Romano baths suitable for more applications we have removed the integrated overflow. You will be able to have an overflow by using an external overflow as shown on page 76.

Natural Stone equivalent is available while stocks last.







LONIO *Natural Stone* The simplistic yet eye catching design of the Lonio bath makes it a flawless choice for those looking to bridge the gap between contemporary and traditional. The thin rim of the bath and the built in Natural Stone legs make this a beautiful centre piece for any bathroom.



Lonio Natural Stone bath, Sapphire floor-standing bath shower mixer, and click-clack bath waste.
See page 63 for technical details on the Lonio bath.

Technical specifications

The following section provides necessary measurements and dimensions for every product in the Clearwater portfolio.

Be sure to co-ordinate your selected exclusive bath with a matching basin, your chosen feet option where necessary, brassware and waste. For more information including installation instructions visit clearwaterbaths.com

Quality Assurance Guarantee

We employ an independent Quality Assurance company to test every batch of products we manufacture, using Accepted Quality Level (AQL) MIL-STD-150E as our standard.

Contents

Baths

- 50 Modern ClearStone Baths
- 58 Modern Natural Stone Baths
- 61 Classic ClearStone Baths
- 63 Classic Natural Stone Baths
- 64 Feet Options

Basins

- 66 Modern Basins
- 67 Classic Basins

Taps

- 68 Modern Taps
- 72 Classic Taps
- 76 Wastes, Traps, Pipes & Overflows
- 78 Fire Hydrant
- 80 Index

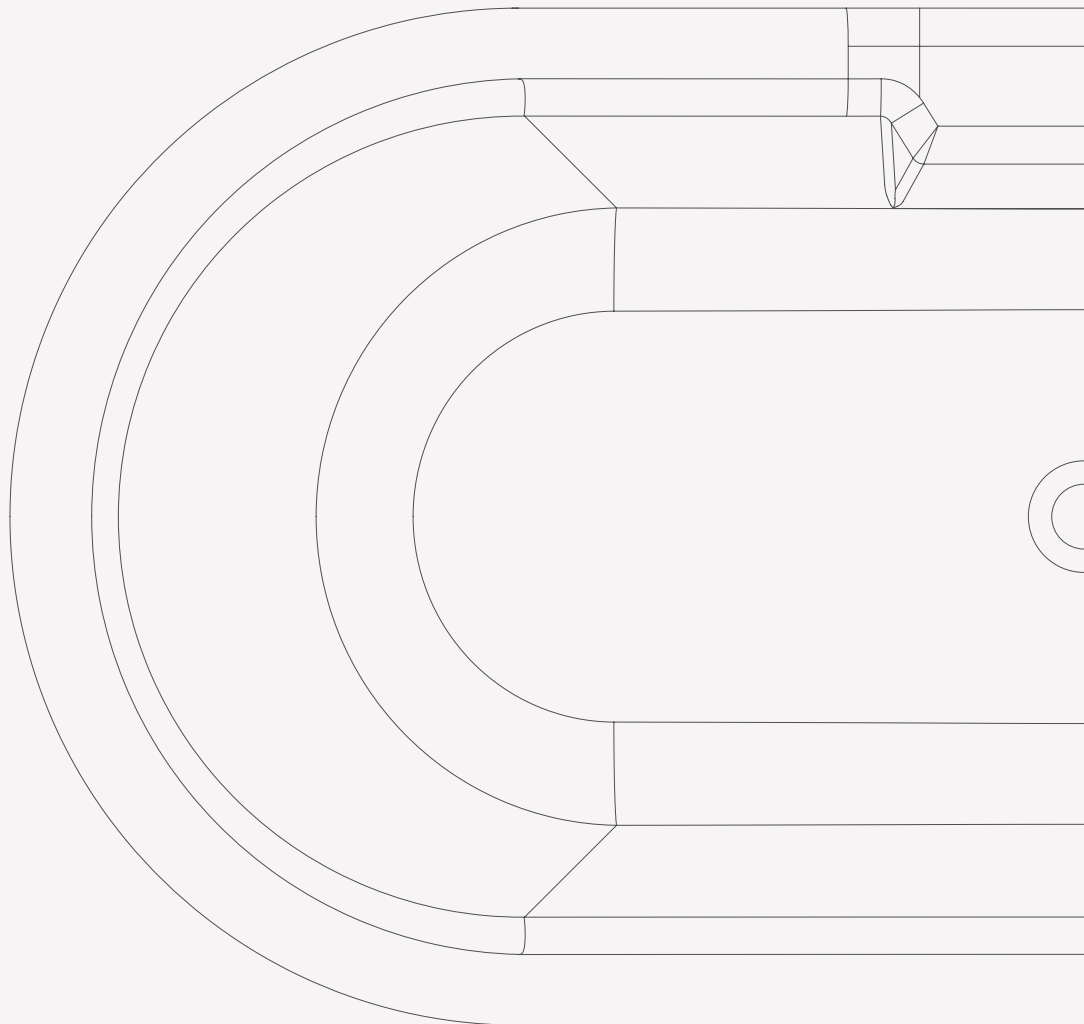

Our Baths

EASY INSTALLATION Every Clearwater bath comes with a simple installation guide. All baths are supplied in individual boxes - so they reach your home in perfect condition. In addition we supply each bath in a carrier bag - so that it is easy for installers to move the bath to the proposed location in your bathroom.



HAND MADE Every Clearwater bath is hand made by three people. It takes over ten hours to hand polish every bath. The baths are 'one piece solid surface baths' meaning there are no joins.

The baths retain that 'brand new look' for many years as small scratches/blemishes can easily be removed.



Modern ClearStone Baths

DUO



Duo ClearStone bath, *page 05*

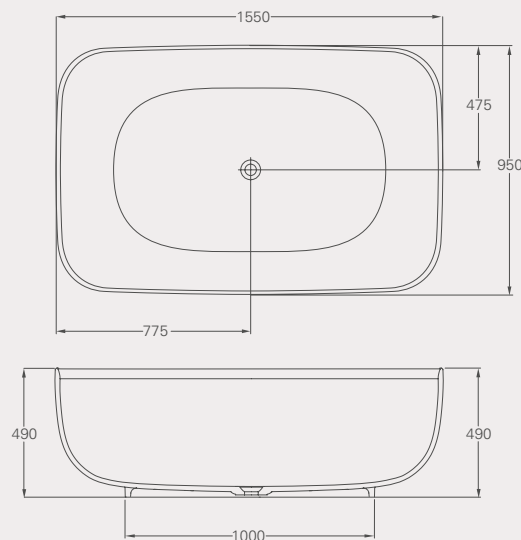

Duo ClearStone bath

L: 1550, W: 950, H: 490

Weight empty: 90 kg

Displaced capacity: 342 litres*

Material: ClearStone

No overflow

Template provided for drilling overflow

Not suitable for rim-mounted taps

Compatible wastes: CW2N, CW2NCS, CW3, CW11, see p76

Code: N26CS

*Displaced capacity is the bath capacity less 70 litres.

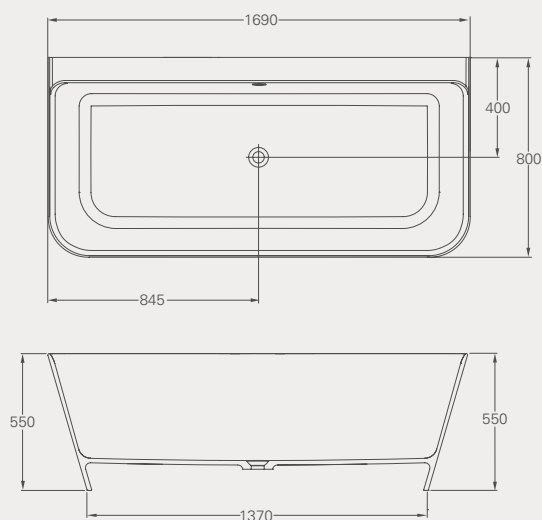
PATINATO GRANDEPatinato Grande ClearStone bath, *page 06***Patinato Grande ClearStone bath**

L: 1690, W: 800, H: 550

Weight empty: 91 kg

Displaced capacity: 204 litres*

Material: ClearStone

No overflow

Template provided for drilling overflow

Suitable for deck mounted taps

Compatible wastes: CW2N, CW2NCS, CW3, CW11, see p76

Code: N3BCS

*Displaced capacity is the bath capacity less 70 litres.

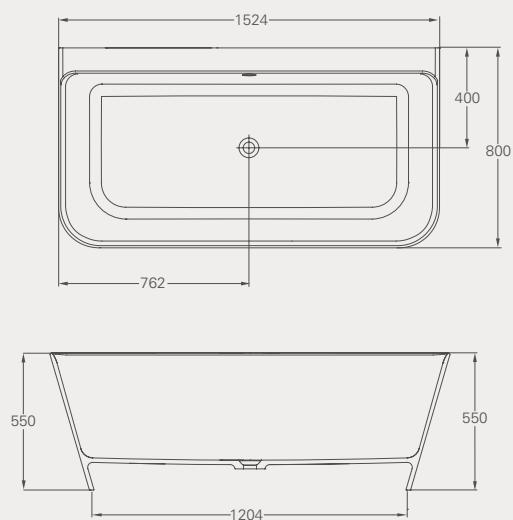
PATINATO PETITEPatinato Petite ClearStone bath, *page 07***Patinato Petite ClearStone bath**

L: 1524, W: 800, H: 550

Weight empty: 85 kg

Displaced capacity: 167 litres*

Material: ClearStone

No overflow

Template provided for drilling overflow

Suitable for deck mounted taps

Compatible wastes: CW2N, CW2NCS, CW3, CW11, see p76

Code: N3ACS

*Displaced capacity is the bath capacity less 70 litres.

Modern ClearStone Baths

FORMOSO GRANDE



Formoso Grande ClearStone bath, *page 09*

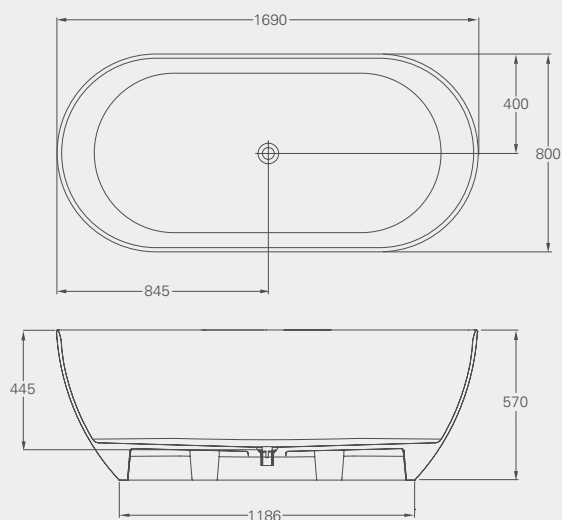

Formoso Grande ClearStone bath

L: 1690, W: 800, H: 570

Weight empty: 84 kg

Displaced capacity: 277 litres*

Material: ClearStone

No overflow

Template provided for drilling overflow

Not suitable for rim-mounted taps

Compatible wastes: CW2N, CW2NCS, CW3, CW11, see p76

Code: N2ACS

*Displaced capacity is the bath capacity less 70 litres.

FORMOSO PETITE



Formoso Petite ClearStone bath, *page 10*

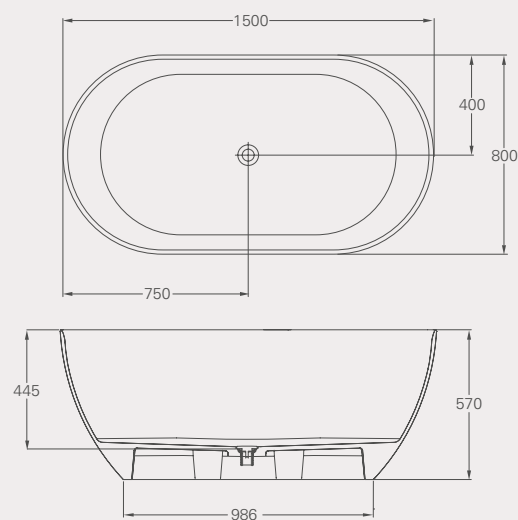

Formoso Petite ClearStone bath

L: 1500, W: 800, H: 570

Weight empty: 67 kg

Displaced capacity: 218 litres*

Material: ClearStone

No overflow

Template provided for drilling overflow

Not suitable for rim-mounted taps

Compatible wastes: CW2N, CW2NCS, CW3, CW11, see p76

Code: N1ACS

*Displaced capacity is the bath capacity less 70 litres.

SONTUOSO



Sontuoso ClearStone bath, *page 12*

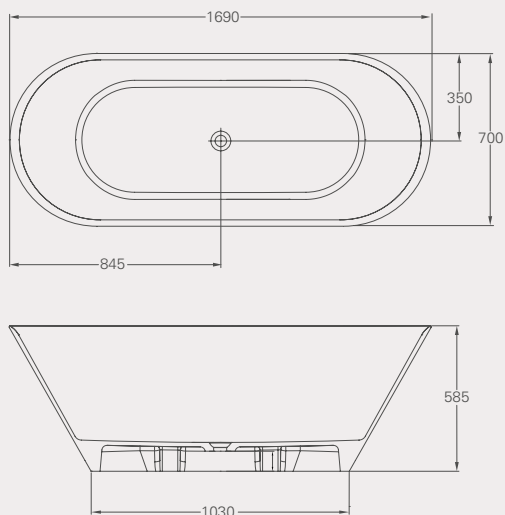

Sontuoso ClearStone bath

L: 1690, W: 700, H: 585

Weight empty: 71 kg

Displaced capacity: 179 litres*

Material: ClearStone

No overflow

Template provided for drilling overflow

Not suitable for rim-mounted taps

Compatible wastes: CW2N, CW2NCS, CW3, CW11, see p76

Code: N8ECS

*Displaced capacity is the bath capacity less 70 litres.

NUVOLA



Nuvola ClearStone bath, *page 16*

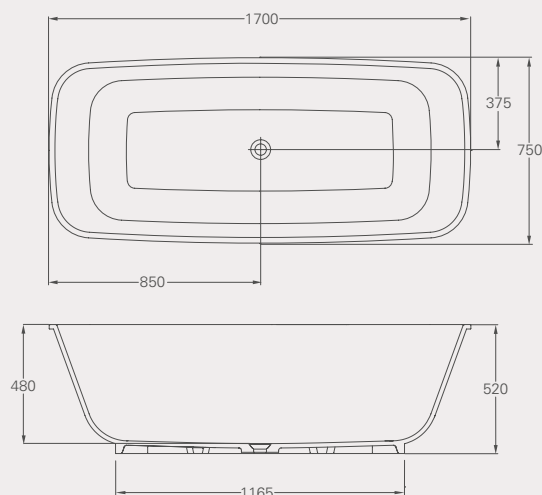

Nuvola ClearStone bath

L: 1700, W: 750, H: 520

Weight empty: 83 kg

Displaced capacity: 242 litres*

Material: ClearStone

No overflow

Template provided for drilling overflow

Not suitable for rim-mounted taps

Compatible wastes: CW2N, CW2NCS, CW3, CW11, see p76

Code: N22CS

*Displaced capacity is the bath capacity less 70 litres.

Modern ClearStone Baths

PURO



Puro ClearStone bath, *page 14*

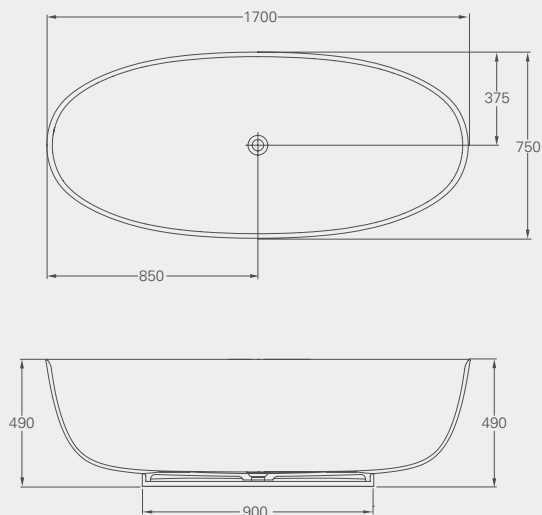

Puro ClearStone bath

L: 1700 W: 750 H: 490

Weight empty: 65kg

Displaced capacity: 203 litres*

Material: ClearStone

No overflow

Template provided for drilling overflow

Not suitable for rim-mounted taps

Compatible wastes: CW2N, CW2NCS, CW3, CW11, see p76

Code: N15CS

*Displaced capacity is the bath's capacity less 70 litres.

PURO WITH PLINTH



Puro ClearStone bath with plinth

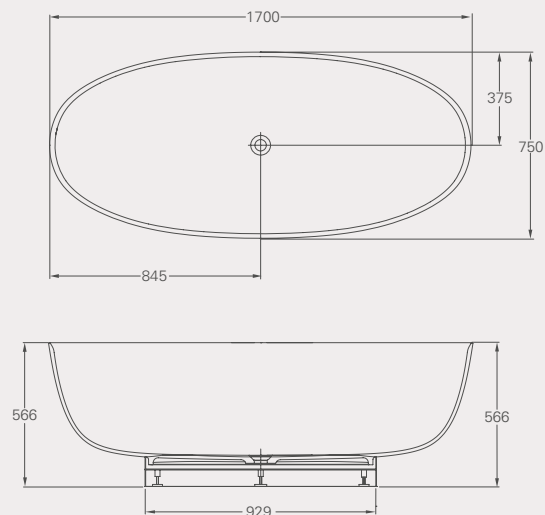

Puro ClearStone bath with plinth

L: 1700 W: 750 H: 566

Weight empty: 85kg

Displaced capacity: 203 litres*

Material: ClearStone with stainless steel plinth

No overflow

Template provided for drilling overflow

Not suitable for rim-mounted taps

Compatible wastes: CW2N, CW2NCS, CW3, CW11, see p76

ClearStone bath: N15CS with plinth: N16PCS

Natural Stone bath: N15 with plinth: N16P

*Displaced capacity is the bath's capacity less 70 litres.

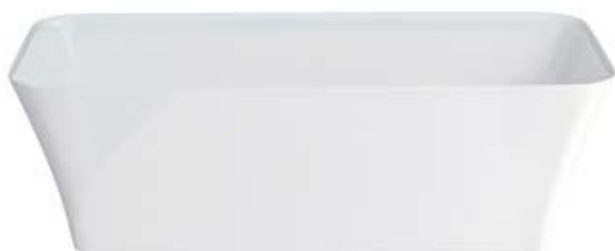
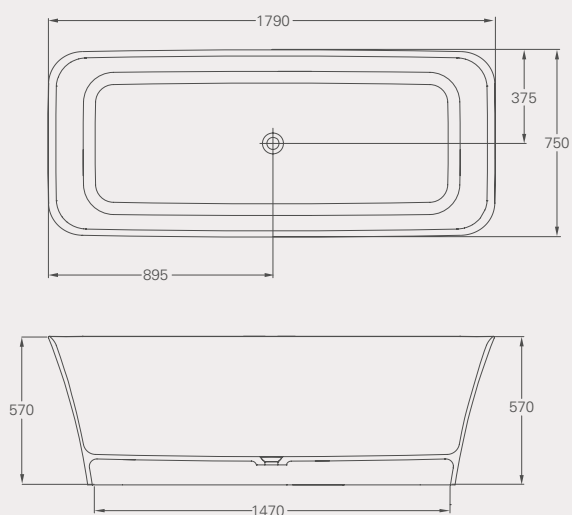
PALERMO GRANDEPalermo Grande ClearStone bath, *page 18***Palermo Grande ClearStone bath**

L: 1790, W: 750, H: 570

Weight empty: 99 kg

Displaced capacity: 261 litres*

Material: ClearStone

No overflow

Template provided for drilling overflow

Not suitable for rim-mounted taps

Compatible wastes: CW2N, CW2NCS, CW3, CW11, see p76

Code: N5CCS

*Displaced capacity is the bath capacity less 70 litres.

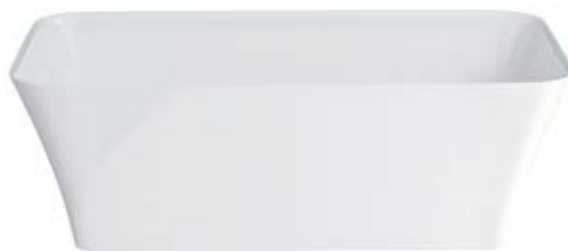
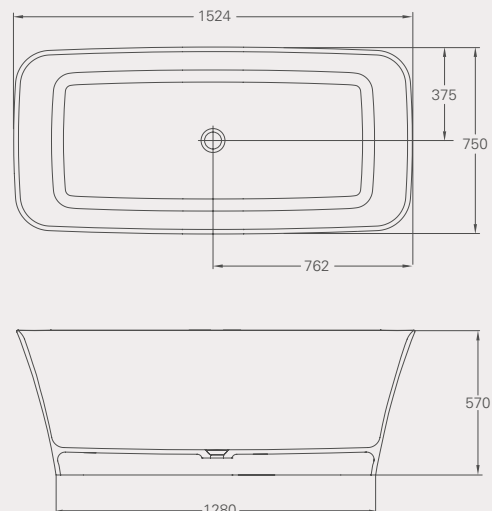
PALERMO PETITEPalermo Petite ClearStone bath, *page 21***Palermo Petite ClearStone bath**

L: 1600, W: 750, H: 570

Weight empty: 87 kg

Displaced capacity: 213 litres*

Material: ClearStone

No overflow

Template provided for drilling overflow

Not suitable for rim-mounted taps

Compatible wastes: CW2N, CW2NCS, CW3, CW11, see p76

Code: N4CCS

*Displaced capacity is the bath capacity less 70 litres.

Modern ClearStone Baths

TEARDROP GRANDE



Teardrop Grande ClearStone bath, *page 22*

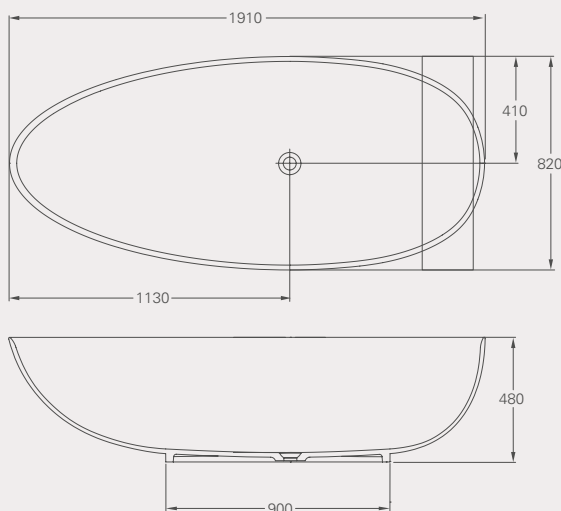

Teardrop Grande ClearStone bath

L: 1910, W: 820, H: 480

Weight empty: 70 kg

Displaced capacity: 211 litres*

Material: ClearStone

No overflow

Template provided for drilling overflow

Not suitable for rim-mounted taps

Compatible wastes: CW2N, CW2NCS, CW3, CW11, see p76

Code: M11FCS

*Displaced capacity is the bath's capacity less 70 litres.

TEARDROP PETITE



Teardrop Petite ClearStone bath, *page 24*

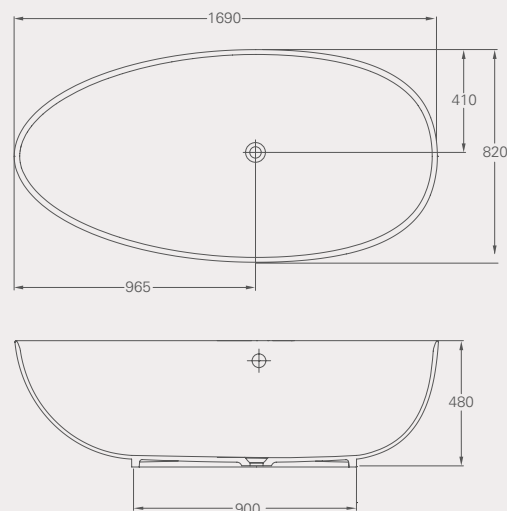

Teardrop Petite ClearStone bath

L: 1690, W: 820, H: 480

Weight empty: 67 kg

Displaced capacity: 190 litres*

Material: ClearStone

No overflow

Template provided for drilling overflow

Not suitable for rim-mounted taps

Compatible wastes: CW2N, CW2NCS, CW3, CW11, see p76

Code: M10FCS

*Displaced capacity is the bath capacity less 70 litres.

VICENZA GRANDE



Vicenza Grande ClearStone bath

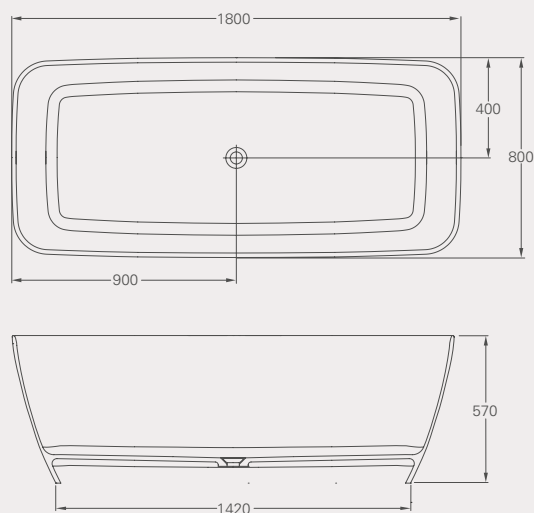

Vicenza Grande ClearStone bath

L: 1800, W: 800, H: 570

Weight empty: 99 kg

Displaced capacity: 294.5 litres*

Material: ClearStone

No overflow

Template provided for drilling overflow

Not suitable for rim-mounted taps

Compatible wastes: CW2N, CW2NCS, CW3, CW11, see p76

Code: N7DCS

*Displaced capacity is the bath capacity less 70 litres.

VICENZA PETITE

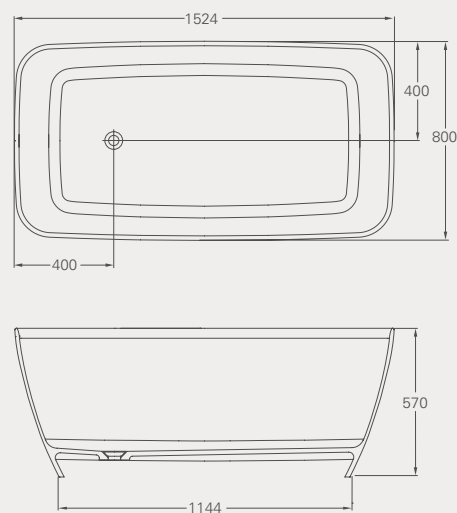
Vicenza Petite ClearStone bath, *page 26*

Vicenza Petite ClearStone bath

L: 1524, W: 800, H: 570

Weight empty: 87 kg

Displaced capacity: 237.5 litres*

Material: ClearStone

No overflow

Template provided for drilling overflow

Not suitable for rim-mounted taps

Compatible wastes: CW2N, CW2NCS, CW3, CW11, see p76

Code: N6DCS

*Displaced capacity is the bath capacity less 70 litres.

Modern Natural Stone Baths

VICENZA



Vicenza Natural Stone bath, *page 28*

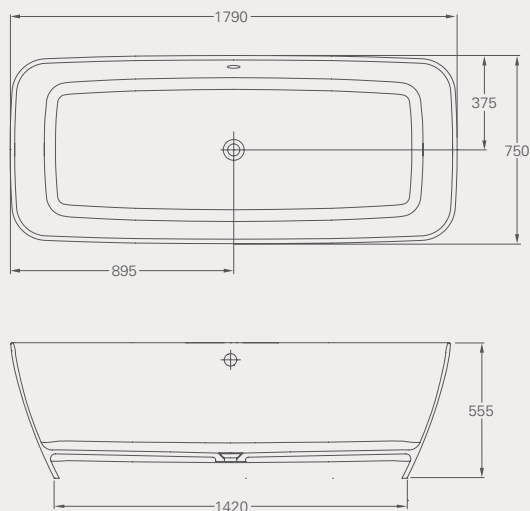

Vicenza Grande Natural Stone bath

L: 1790, W: 750, H: 555

Weight empty: 138 kg

Displaced capacity: 295 litres*

Material: Natural Stone

Integrated overflow

Not suitable for rim-mounted taps

Compatible wastes: CW1, CW1N, CW3, see p76

Code: N7D

*Displaced capacity is the bath capacity less 70 litres.

VICENZA PICCOLO



Vicenza Piccolo Natural Stone bath

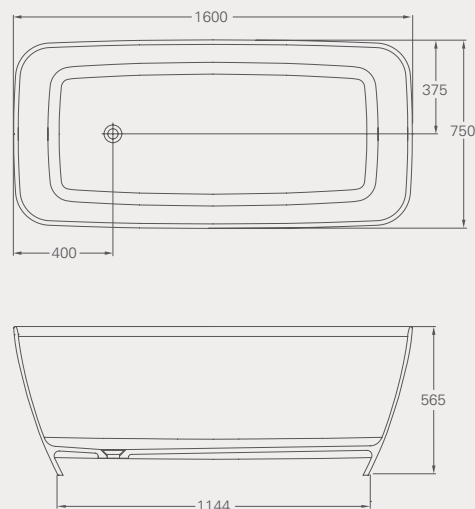

Vicenza Piccolo Natural Stone bath

L: 1600, W: 750, H: 565

Weight empty: 111 kg

Displaced capacity: 255 litres*

Material: Natural Stone

Integrated overflow

Not suitable for rim-mounted taps

Compatible wastes: CW1, CW1N, CW3, see p76

Code: N6D

*Displaced capacity is the bath capacity less 70 litres.

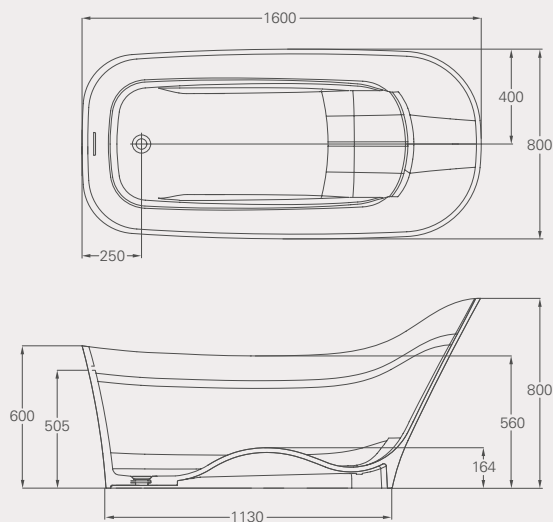
NEBBIANebbia Natural Stone bath, *page 30***Nebbia Natural Stone bath**

L: 1600, W: 800, H: 600/800

Weight empty: 117 kg

Displaced capacity: 230 litres*

Material: Natural Stone

Integrated overflow

Not suitable for rim-mounted taps

Compatible wastes: CW1, CW1N, CW3, see p76

Code: N14

*Displaced capacity is the bath capacity less 70 litres.

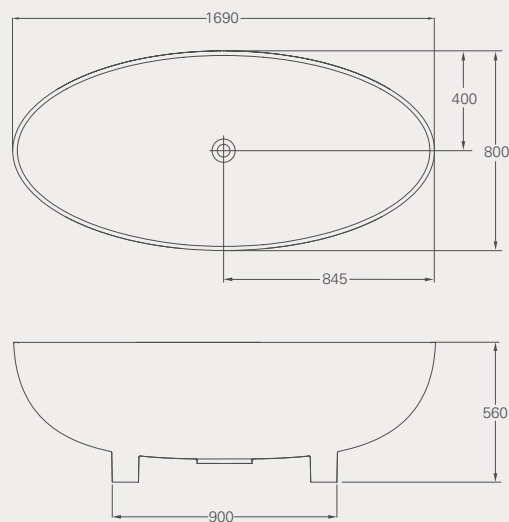
LACRIMALacrima Natural Stone bath, *page 33***Lacrima Natural Stone bath**

L: 1690, W: 800, H: 560

Weight empty: 93 kg

Displaced capacity: 230 litres*

Material: Natural Stone

Integrated overflow

Not suitable for rim-mounted taps

Compatible wastes: CW1, CW1N, CW3, W21, see p76

Code: N12

*Displaced capacity is the bath capacity less 70 litres.

Modern Natural Stone Baths

VIGORE



Vigore Natural Stone bath, *page 34*

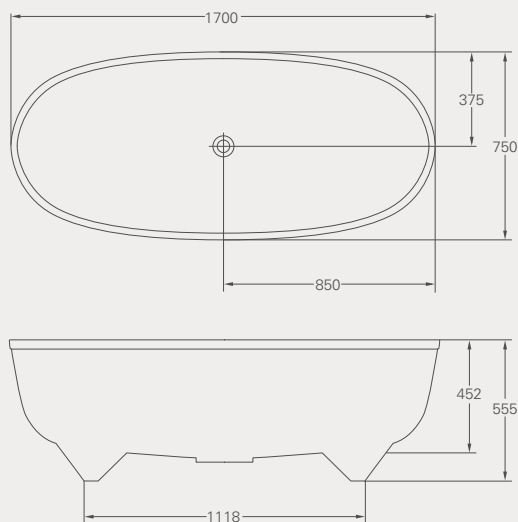

Vigore Natural Stone bath

L: 1700, W: 750, H: 555

Weight empty: 120 kg

Displaced capacity: 219 litres*

Material: Natural Stone

Integrated overflow

Not suitable for rim-mounted taps

Compatible wastes: CW1, CW1N, CW3, see p76

Code: N17

*Displaced capacity is the bath's capacity less 70 litres.

ARMONIA



Armonia Natural Stone bath, *page 36*

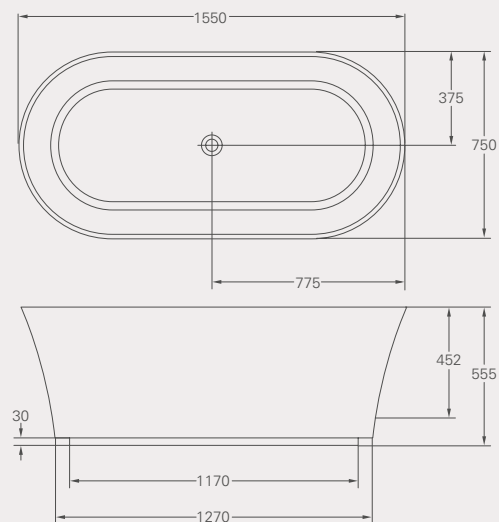

Armonia Natural Stone bath

L: 1550, W: 750, H: 555

Weight empty: 110kg

Displaced capacity: 222 litres*

Material: Natural Stone

Integrated overflow

Not suitable for rim-mounted taps

Compatible wastes: CW1, CW1N, CW3, see p76

Code: N18

*Displaced capacity is the bath's capacity less 70 litres.

Classic ClearStone Baths

BALTHAZAR



Balthazar ClearStone bath, *page 39*

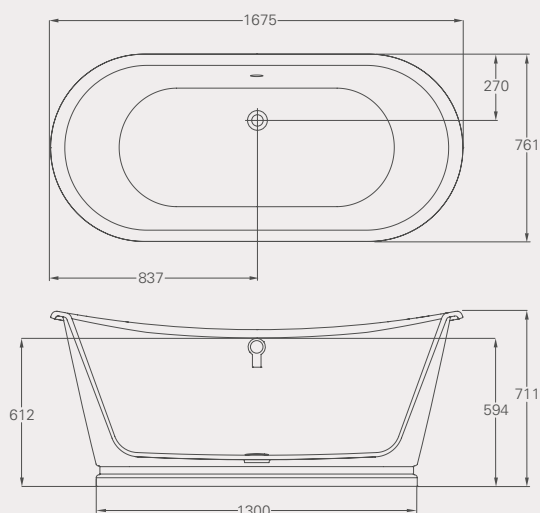

Balthazar ClearStone bath

L: 1675, W: 761, H: 711

Weight empty: 111 kg

Displaced capacity: 164 litres*

Material: ClearStone with stainless steel outer of bath

Overflow pre-drilled

Not suitable for rim-mounted taps

Compatible wastes: W4, CW11, CW3, see p76

Code: N25CS

*Displaced capacity is the bath capacity less 70 litres.

CLASSICO GRANDE



Classico Grande ClearStone bath, *page 40*

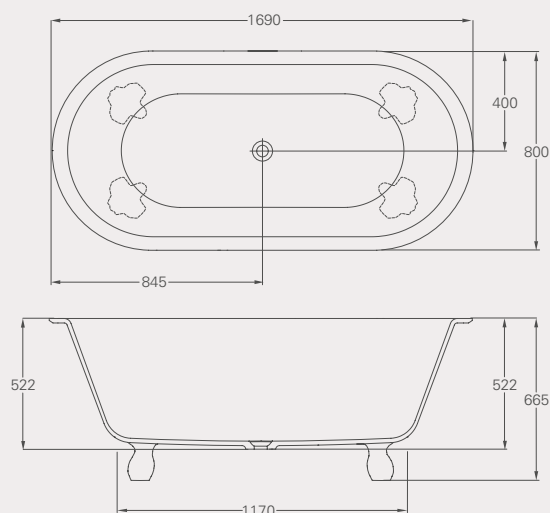

Classico Grande ClearStone bath with chrome Claw feet

L: 1690, W: 800, H: 655

Weight empty: 69 kg

Displaced capacity: 169 litres*

Material: ClearStone

Overflow un-drilled

Not suitable for rim-mounted taps

Compatible wastes: CW2N, CW2NCS, W4, CW3,

CW11, W21, W8N, see p76

Code: N9CS Please specify the feet required at the time of ordering

*Displaced capacity is the bath capacity less 70 litres.

Classic ClearStone Baths

BATELLO



Batello ClearStone bath, *page 42*

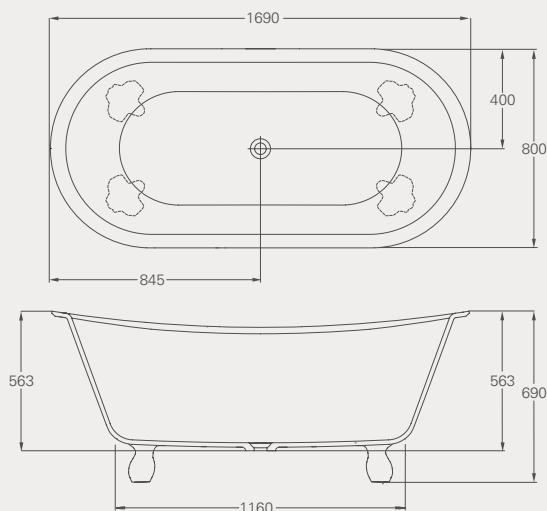

Batello ClearStone bath with chrome Classic feet

L: 1690, W: 800, H: 690

Weight empty: 66 kg

Displaced capacity: 151 litres*

Material: ClearStone

Overflow un-drilled

Not suitable for rim-mounted taps

Compatible wastes: CW2N, CW2NCS, W4, CW3, CW11, W21, W8N, see p76

Code: N10CS Please specify the feet required at the time of ordering

*Displaced capacity is the bath capacity less 70 litres.

ROMANO GRANDE



Romano Grande ClearStone bath, *page 45*

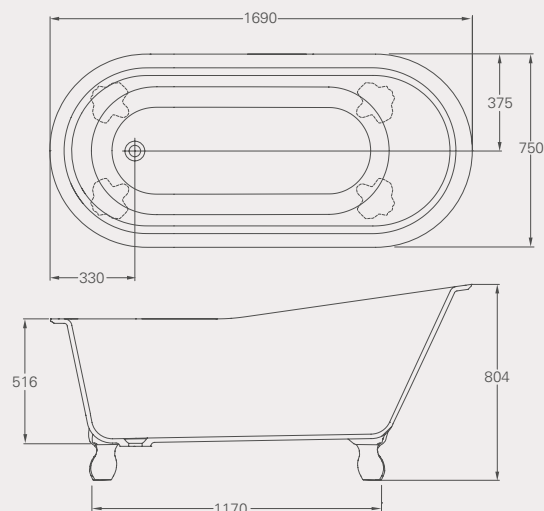

Romano Grande ClearStone bath with chrome Classic feet

L: 1690, W: 750, H: 516/804

Weight empty: 75 kg

Displaced capacity: 167 litres*

Material: ClearStone

Overflow un-drilled

Not suitable for rim-mounted taps

Compatible wastes: CW2N, CW2NCS, W4, CW3, CW11, W21, W8N, see p76

Code: N11BCS Please specify the feet required at the time of ordering

*Displaced capacity is the bath capacity less 70 litres.

Classic Natural Stone Bath

ROMANO PETITE



Romano Petite ClearStone bath, *page 44*

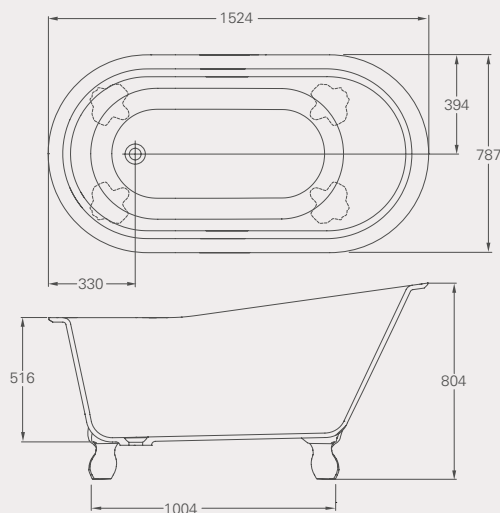

Romano Petite ClearStone bath with chrome Classic feet

L: 1524, W: 787, H: 516/804

Weight empty: 69 kg

Displaced capacity: 129 litres*

Material: ClearStone

Overflow un-drilled

Not suitable for rim-mounted taps

Compatible wastes: CW2N, CW2NCS, W4, CW3, CW11, W21, W8N, see p76

Code: N11ACS Please specify the feet required at the time of ordering

*Displaced capacity is the bath capacity less 70 litres.

LONIO



Lonio Natural Stone bath, *page 47*

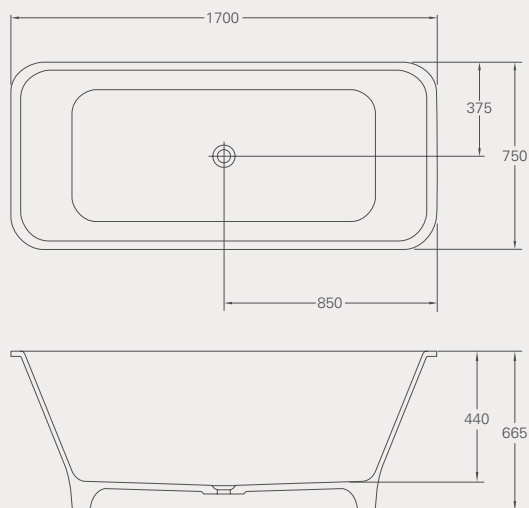

Lonio Natural Stone bath

L: 1700, W: 750, H: 615

Weight empty: 125 kg

Displaced capacity: 239 litres*

Material: Natural Stone

No overflow

Not suitable for rim-mounted taps

Compatible wastes: CW2, CW2N, CW3, W8N, see p76

Code: N19

*Displaced capacity is the bath's capacity less 70 litres.



See website for more details



Chrome

Claw Feet (L1)



Chrome **L1C**



White **L1W**

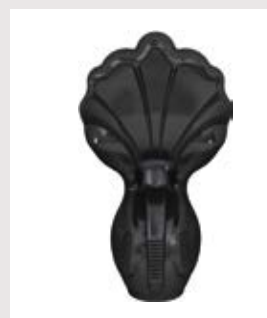

Black **L1B**

Legs included within the bath price for Classico, Romano and Batello baths.

Shrouds and Stand Pipes



Decorative shrouds

These are for use with baths with rim-mounted fittings and can be used with deck-mounted taps.

D: 70, W: 70, H: 709

Code: W6

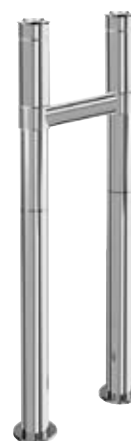

Stand pipes including horizontal support bar

These are for use with baths where fittings are not rim or wall-mounted (Water runs through the pipes). Can be used with deck-mounted taps.

D: 100, W: 280, H: 600

Code: W7

Modern Basins

CLEARSTONE



Brochure page 10

Formoso ClearStone basin

D: 350, W: 550, H: 142

Material: ClearStone

Compatible wastes: W22

Code: B1ACS



Brochure page 21

Palermo ClearStone basin

D: 350, W: 550, H: 142

Material: ClearStone

Compatible wastes: W22

Code: B3CCS



Brochure page 25

Teardrop ClearStone basin

L: 350, W: 550, H: 142

Material: ClearStone

Compatible wastes: W22

Code: B10ECS



Brochure page 14

Puro ClearStone basin

D: 350, W: 550, H: 142

Material: ClearStone

Compatible wastes: W22

Code: B13ECS



Sontuoso ClearStone basin

D: 350, W: 550, H: 142

Material: ClearStone

Compatible wastes: W22

Code: B5ECS

NATURAL STONE



Brochure page 13

Sontuoso Natural Stone basin

D: 390, W: 590, H: 140

Material: Natural Stone

Compatible wastes: W22

Code: B5E



Brochure page 26

Vicenza Natural Stone basin

L: 390, W: 590, H: 140

Material: Natural Stone

Compatible wastes: W22

Code: B4D



ON ALL MODERN & CLASSIC BASINS

See website for more details

Classic Basins



Small roll top with overflow

D: 470, W: 550, H: 170

Material: Natural Stone

tap hole option 0, 1, 2, 3

Supplied un-drilled

Compatible wastes: W11, W18

Code: B7E



Medium roll top with overflow

D: 470, W: 650, H: 170

Material: Natural Stone

tap hole option 0, 1, 2, 3

Supplied un-drilled

Compatible wastes: W11, W18

Code: B8E



Large roll top with overflow

D: 470, W: 750, H: 170

Material: Natural Stone

tap hole option 0, 1, 2, 3

Supplied un-drilled

Compatible wastes: W11, W18

Code: B9E



Small roll top with
stainless steel Stand

D: 470, W: 550, H: 880

Material: Natural Stone

Basin: B7E Stand: B7ES



Brochure page 40

Medium roll top with
stainless steel Stand

D: 470, W: 650, H: 880

Material: Natural Stone

Basin: B8E Stand: B8ES



Large roll top with
stainless steel Stand

D: 470, W: 750, H: 880

Material: Natural Stone

Basin: B9E Stand: B9ES

All Natural Stone basins are supplied without pre-drilled tap holes.

Possible options are denoted by 'tap hole option' *shown above*

All measurements shown are represented in mm, all overflow holes are not pre-drilled unless otherwise stated.

Sapphire Bath & Basin Taps



Bath filler on stand pipes

Floor-standing
D: 179, W: 232, H: 895

Bath filler: CTA15
Stand pipes: W7



Bath shower mixer filler
on stand pipes

Floor-standing
D: 179, W: 302, H: 895

Bath filler: CTA16
Stand pipes: W7

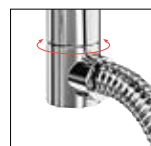

Detail of swivelling hose mount

Bath shower mixer

D: 179, W: 302, H: 250

Code: CTA16



Single-lever bath filler
on stand pipe

Floor-standing
D: 200, W: 55, H: 898

Bath filler: CTA14
Stand pipes: W24



Decorative shrouds

These are for use with baths
with rim-mounted fittings
D: 70, W: 70, H: 709

Code: W6



Stand pipes including
horizontal support bar

These are for use with baths where
fittings are not rim or wall-mounted
(Water runs through the pipes)

D: 100, W: 280, H: 600

Code: W7



Single-lever bath filler
D: 200, W: 55, H: 162
Code: CTA14



Bath filler
D: 179, W: 232, H: 159
Code: CTA15



Mini basin mixer
without waste
D: 145, W: 48, H: 146
Code: CTA10



Tall basin mixer
without waste
D: 150, W: 52, H: 313
Code: CTA12



Basin mixer
without waste
D: 150, W: 52, H: 154
Code: CTA9



Basin mixer with
pop-up waste
D: 162, W: 52, H: 154
Code: CTA11

Bathing in technology®

- Brass taps & heads
- Chrome plated to EN817 & EN200 and level 10 salt spray tested
- 50cm G 1/2 flexible tails
- Mixers are fitted with a flow straightener for low pressure installations
- A high pressure aerator is provided with every mixer for high pressure installations
- All mixers work on 0.2 bar to 5 bar pressure (i.e are low and high pressure taps)



ON ALL
SAPPHIRE TAPS
See website for more details

Crystal Bath & Basin Taps



Bath filler on stand pipes

Floor-standing
D: 175, W: 232, H: 904

Bath filler: CTA6
Stand pipes: W7



Detail of
swivelling
hose mount

Bath shower mixer on stand pipes

Floor-standing
D: 175, W: 302, H: 905

Bath filler: CTA7
Stand pipes: W7



Bath shower mixer

Rim-mounted
D: 175, W: 302, H: 250

Code: CTA7



Single-lever bath filler on stand pipe

Floor-standing
D: 196, W: 55, H: 903

Bath filler: CTA5
Stand pipes: W24



Decorative shrouds

These are for use with baths
with rim-mounted fittings
D: 70, W: 70, H: 709

Code: W6



Stand pipes including
horizontal support bar

These are for use with baths where
fittings are not rim or wall-mounted
(Water runs through the pipes)
D: 100, W: 280, H: 600

Code: W7



Single-lever bath filler
D: 196, W: 55, H: 166
Code: CTA5



Bath filler deck-mounted
D: 175, W: 232, H: 169
Code: CTA6



Mini basin mixer
without waste
D: 138, W: 48, H: 150
Code: CTA8



Tall basin mixer
without waste
D: 137, W: 52, H: 324
Code: CTA3



Basin mixer
without waste
D: 137, W: 52, H: 164
Code: CTA1



Basin mixer with
pop-up waste
D: 138, W: 52, H: 164
Code: CTA2

Bathing in technology®

- Brass taps & heads
- Chrome plated to EN817 & EN200 and level 10 salt spray tested
- 50cm G 1/2 flexible tails
- Mixers are fitted with a flow straightener for low pressure installations
- A high pressure aerator is provided with every mixer for high pressure installations
- All mixers work on 0.2 bar to 5 bar pressure (i.e are low and high pressure taps)



ON ALL
CRYSTAL TAPS
See website for more details

Burlington Bath Taps

Clearwater has paired up with Burlington to offer a range of beautiful, Classic brassware perfectly matched to your chosen Clearwater bath or basin. Choose from either the Anglesey, Claremont, Birkenhead or Kensington tap head ranges and add these to basin taps, bath fillers or bath shower mixers packed with innovative technology and unique features.

For more information on the water saving benefits and innovative design features of Burlington taps, please see the Burlington brochure or visit burlingtonbathrooms.com



QUARTER *turn*

All our taps (except Kensington) come with the classic screw down valves as standard.

For 'Quarter Turn' simply add 'QT' to the product code.

TAP HEADS

All available with any tap base for all applications



Anglesey

Add AN to the start of the code



Claremont

Add CL to the start of the code



Birkenhead

Add BI to the start of the code



Kensington

(Quarter turn only)

Add KE to the start of the code

STANDARD OR REGENT

All available with any tap base for all applications

Standard

To turn your standard taps into taps with Regent bases, simply add 'R' to your code. For example; your Claremont 3" basin taps (CL1) become Claremont Regent 3" basin taps (CLR1).

All our taps (except Kensington) come with the Classic screw down valves as standard. For 'Quarter Turn' simply add 'QT' to the product code.



Regent

Regent tap bases have been designed so that the spouts are 3cm higher off the bath/basin (and a further 3cm away from the wall in the case of Regent wall-mounted taps) than their equivalent namesake. This creates an opulent feel and, in certain commercial applications, ensures compliance with some archaic building regulations.



Claremont deck-mounted bath shower mixer with "S" adjuster,
see page 74 for details



Burlington Bath Taps

DECK-MOUNTED



Bath shower mixer deck-mounted with "S" adjuster

Standard
Code: CL15
Regent
Code: CLR15



Angled Bath shower mixer deck-mounted with "S" adjuster

Standard
Code: CL19
Regent
Code: CLR19



Bath filler deck-mounted

Standard
Code: CL23
Regent
Code: CLR23



Angled bath filler deck-mounted

Standard
Code: CL25
Regent
Code: CLR25



Bath tap deck-mounted

Standard
Code: CL3
Regent
Code: CLR3

WALL-MOUNTED



Bath shower mixer wall-mounted with "S" adjuster

Standard
Code: CL17
Regent
Code: CLR17



Angled bath shower mixer wall-mounted with "S" adjuster

Standard
Code: CL21
Regent
Code: CLR21



Bath filler wall-mounted

Standard
Code: CL24
Regent
Code: CLR24



Angled bath filler wall-mounted

Standard
Code: CL26
Regent
Code: CLR26

Burlington Basin Taps

ONE TAP HOLE



Basin mixer with high central indice with click-clack waste

Standard

Code: CL6

Regent

Code: CLR6



Basin mixer with high central indice with pop-up waste

Standard

Code: CL4

Regent

Code: CLR4



Basin mixer with high central indice with plug and chain waste

Standard

Code: CL5

Regent

Code: CLR5

TWO TAP HOLE



Basin tap 3"

Standard

Code: CL1

Regent

Code: CLR1



Basin tap 5"

Standard

Code: CL2

Regent

Code: CLR2



2 tap hole Bridge mixer with high central indice with plug and chain waste

Standard

Code: CL10

Regent

Code: CLR10



2 tap hole Arch mixer with curved spout (200mm centres)

Standard

Code: CL27

Regent

Code: CLR27

THREE TAP HOLE



3 tap hole mixer with pop-up waste

Standard

Code: CL12

Regent

Code: CLR12



3 tap hole thermostatic mixer with pop-up waste

Please note that Kensington levers are not suitable to be fitted to this product.

Code: CL29

Bathing in technology

- Brass taps & heads
- Chrome plated to EN817 & EN200 and level 10 salt spray tested
- mixers are fitted with a flow straightener for low pressure installations
- A high pressure aerator is provided with every mixer for high pressure installations
- All mixers work on 0.2 bar to 5 bar pressure (i.e are low and high pressure taps)

Bath and Basin Overflows, Pipes, Traps & Wastes



Special bath waste for baths without a pre-drilled overflow hole (with un-slotted click-clack waste)

D: 70, W: 70, H: 794

Code: CW11



Exposed bath overflow, plug & chain

D: 318, W: 75, H: 565

Code: W4

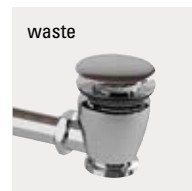
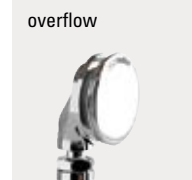

Exposed bath overflow, click-clack waste

D: 318, W: 75, H: 565

Code: CW6



Click-clack bath waste slotted with polished finish Natural Stone cover

D: 70, W: 70, H: 60

For use with Natural Stone baths

Code: CW1N



Click-clack bath waste unslotted with polished finish Natural Stone cover

D: 70, W: 70, H: 55

For use with ClearStone baths

Code: CW2N



Click clack bath waste unslotted white gloss ClearStone cover

D: 70, W: 55, H: 20

For use with ClearStone baths

Code: CW2NCS



Click-clack bath waste slotted

D: 70, W: 70, H: 60

For use with Natural Stone baths

Code: CW1



Click-clack bath waste unslotted
D: 70, W: 70, H: 55
For use with ClearStone baths
Code: CW2



P-trap
D: 50, W: 117, H: 86
For use with baths with exposed pipe work
Code: CW3



P-trap Connection Pipe
D: 40, L: 872, H: 220
Pipe length can be cut to size on site
Code: W21



Click-clack basin waste slotted
D: 61, W: 61, H: 71
Code: W11



Click-clack basin waste unslotted
D: 61, W: 61, H: 86
Code: W22



Flip-top basin waste slotted
D: 61, W: 61, H: 71
Code: W18



Classic basin bottle trap
L: 367, W: 67, H: 197
Pipe length can be cut to size on site
Code: W14



Flat bottom basin bottle trap
D: 362, W: 67, H: 180
Pipe length can be cut to size on site
Code: W13



Flat bottom bottle trap
(easy access for hair removal or finding lost jewellery!!)

Fire Hydrant

for the ultimate classic look



Fire Hydrants can be fitted to the following classic baths:



**CLASSICO
GRANDE**
ClearStone
See page 40



BATELLO
ClearStone
See page 42



**ROMANO
PETITE**
ClearStone
See page 44



**ROMANO
GRANDE**
ClearStone
See page 45



LONIO
Natural Stone
See page 47

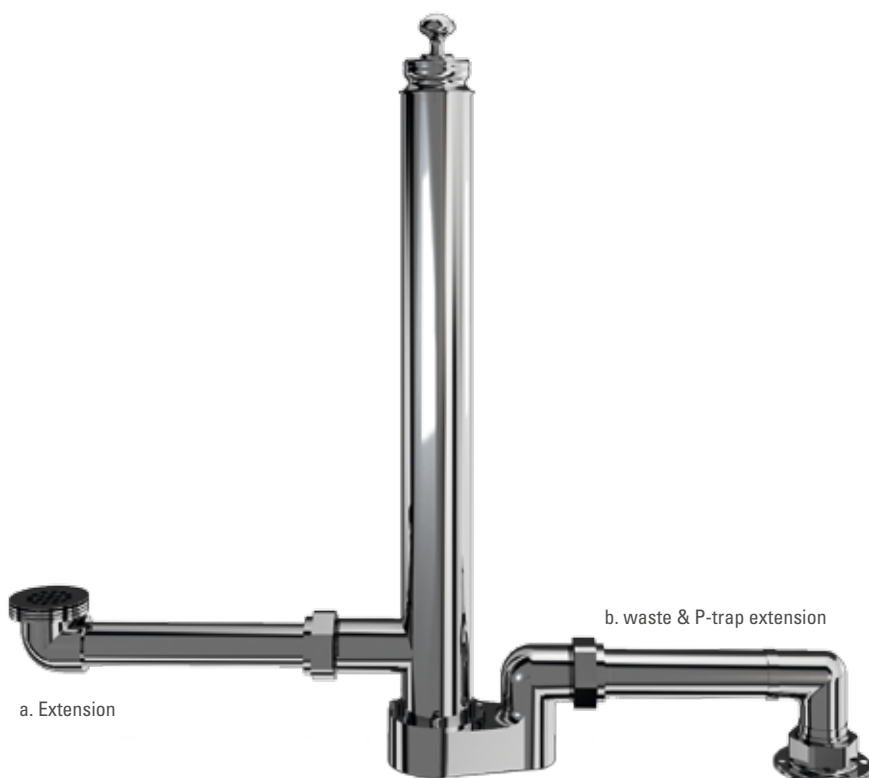

Classic Fire Hydrant
Supplied with extension and
P-trap waste & extension
D: 795, W: 119, H: 697
Code: W8N

a. Extension*
* Allows the waste pipe to be fitted up to 950mm
away from the centre of the bath waste hole.
b. waste & P-trap Extension*
* Allows the waste pipe to be situated
up to 500mm away from the waste.

Technology

Named Fire Hydrant due to its classic design, this is a very distinctive waste system that operates from the plug hole. Water fills the hydrant which incorporates a built in overflow and plug system, simply lift the handle to empty your bath. This waste system adds a level of opulence to your bathroom.



Fire Hydrant technology

The waste pipe in our 'Fire Hydrant' is designed so that you can change the angles to fit into your waste in the floor.

Fire Hydrants can be used in a free-standing position.

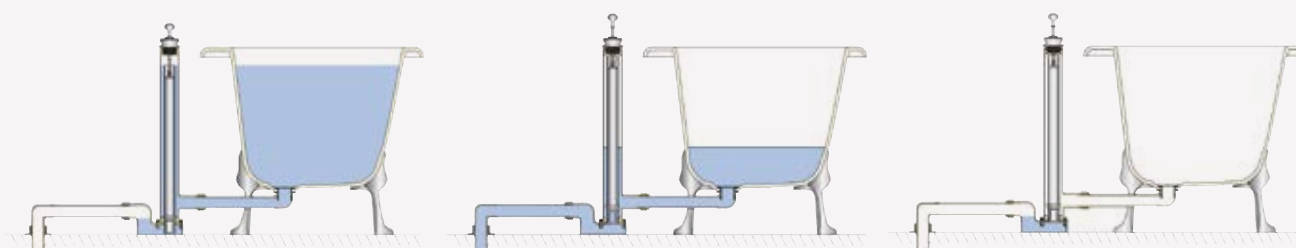

Full bath using overflow

Emptying bath

Empty bath



ON ALL
FIRE HYDRANTS
See website for more details

Modern Stone Baths



DUO
ClearStone
See page 05



**PATINATO
GRANDE**
ClearStone
See page 06



**PATINATO
PETITE**
ClearStone
See page 07



**FORMOSO
GRANDE**
ClearStone
See page 09



**FORMOSO
PETITE**
ClearStone
See page 10



SONTUOSO
ClearStone
See page 12



PURO
ClearStone
See page 14



**PURO WITH
PLINTH**
ClearStone



NUVOLA
ClearStone
See page 16



**PALERMO
GRANDE**
ClearStone
See page 18



**PALERMO
PETITE**
ClearStone
See page 21



**TEARDROP
GRANDE**
ClearStone
See page 22



**TEARDROP
PETITE**
ClearStone
See page 24



**VICENZA
GRANDE**
*Natural Stone
& ClearStone*
See page 28



**VICENZA
PETITE**
ClearStone
See page 26



**VICENZA
PICCOLO**
Natural Stone
See page 28



NEBBIA
Natural Stone
See page 30



LACRIMA
Natural Stone
See page 33



VIGORE
Natural Stone
See page 34



ARMONIA
Natural Stone
See page 36

Classic Baths



BALTHAZAR
ClearStone
See page 39



**CLASSICO
GRANDE**
ClearStone
See page 40



**BATELLO
GRANDE**
ClearStone
See page 42



**ROMANO
GRANDE**
ClearStone
See page 45



**ROMANO
PETITE**
ClearStone
See page 44



LONIO
Natural Stone
See page 47



CLEARWATER BATHS, MADE FROM THE HIGHEST QUALITY MATERIALS

ClearStone. Our innovative new, lightweight material not only looks the part with its ability to craft softer, more elegant bath designs, each with a high gloss lustrous finish and a typical weight reduction of 30% too, ensuring your bathroom looks its best for years to come. ClearStone has a unique ability to retain its appearance with a high resistance to scratches and damage. Any minor damage that may occur can simply be filled, coated and polished on site using a ClearStone repairing kit.

ClearStone Repair Kits

Kit includes: 25 ml Clearstone, 50 ml polishing compound, Small cup for mixing, 800, 1200 and 1500 grate sand paper and 19g MEKP catalyst

Code: CRK



**10 YEAR GUARANTEE
ON ALL OUR BATHS**
See website for more details

